



Grepi™ 8 x 60

Grepi

The **unique** fastener system for lightweight and porous concrete

5 pack and 25 pack

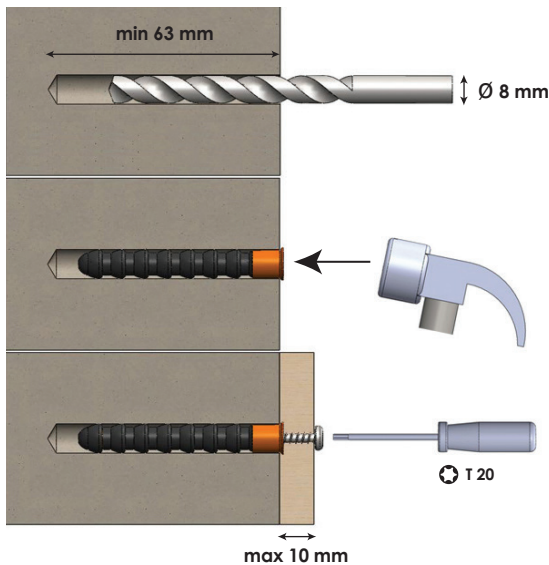

1

Drill the hole using a 8mm bit.
Wipe away any dust (not illustrated)

2

Carefully tap the plug into the hole.
Use a suitable hammer or mallet

3

Insert screw into plug and tighten.
Use a T20 Torx screwdriver or socket

Maximum depth of item to be mounted is 10mm

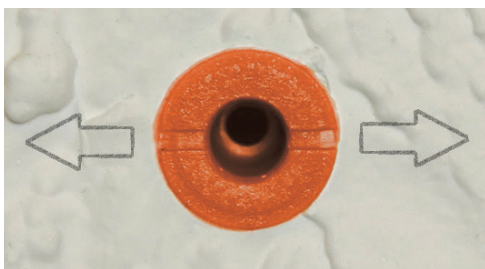

The direction of expansion is indicated on the plug, enabling you to control the direction in which the plug expands when fixing items close to the edge of a block.

Benefits

- High load values
- Easy to install
- Self-centering design of the screw
- Varying temperature ranges
- Shock-absorbing design
- Soft outer thermoplastic skin prevents rotation
- Screw with high corrosion resistance, class c4 or C5m all with Torx recess

Material data

- Plug material: PA6 (Polyamide 6) with TPR (Thermoplastic rubber) outer skin
- Screw material: Carbon steel hardened, C4 coating (1500 hours) NiZN
- Temperature range: From -20°C to +60°C

Rec. Load Values are based on safety factor of 3

- LWC (500) / expanded clay (kN) 0.35
- Concrete C25 (kN) 0.50

Grepi Plast AS

Røraskogen 12

3739 SKIEN

Norway

Tlf: + 47 35504130

E-post: post@grepi.no

For orders and further information please visit www.grepi.no

grepi plast
A Mezon Company